



Automatic Gate barrier with
smartphone control feature

Automatic closing feature

Adjustable folding arms (3-6m)

Obstacle detection

Manual control possibility

Secure operation with safety devices

Parklio™ Gate

USER MANUAL



Dear Customers,

Thank you for purchasing our parking gate barrier!

We hope that this product meets all your expectations. Parklio Automatic Gate Barrier is manufactured using the latest technologies and has undergone rigorous quality control procedures.

The User Guide will assist you in quickly and safely using your product.

This manual's information is subject to change without notice.

Attention!

- Please read the user manual and technical sheet before installing and using the Parklio smart parking Gate.
- Always follow the safety instructions.
- Keep this user manual at hand for future reference.

TABLE OF CONTENTS

User information	4
Parking Gate components	5
Gate components overview	5
Dimensions	6
Technical characteristics	7
Installation	9
Preliminary checks	9
Installing base plate (up to 4m)	9
Installing the Gate barrier (up to 4m)	10
Installing base plate (up to 6m)	11
Installing the Gate barrier (up to 6m)	12
Installing the Gate barrier	13
Support and boom installation	14
Electrical connections	15
Installation of the Gate cover	16
Release and lock procedure	17
Controlling the Gate	19
Installing the application	19
Register and login	20
Adding the barrier	21
Connecting to the Gate	22
Opening and closing the barrier	23
Gate settings and information	23
Gate key reset	27
Maintenance	28
Disposal	29
Safety warnings	29
FAQ	31

1. User information

The Parklio Gate is designed to be safe and durable for many years with basic maintenance on your part. However, even though the gate barrier meets all safety standards, there is still the possibility of an accident occurring due to improper use. To avoid difficulties when operating the gate, read our advice below:

- Before using the Parklio Gate for the first time, ask the installer to explain the sources of residual risk to you. After that take some time to carefully read the instruction manual and user information delivered by the installer.
- Keep the manual for future reference and give it to any new device owners or operators.
- Your Gate is a parking protection product that faithfully obeys your commands; however, irresponsible and improper use can make it dangerous: do not begin moving the device if there are people, animals, or objects within its radius of action.
- Children: Because it is installed in accordance with technical standards, our gate provides a high level of safety for children. However, it is critical to prevent children from playing near the gate as well as unsupervised use; the gate remote controller is not a toy, and it should never be left within children's reach!
- Irregularities in operation: If you notice any problems with the gate's operation, turn it off and perform manual unblocking. Do not attempt to repair the gate yourself; instead, contact your installer; in the meantime, the system can operate as a non-automated device.
- Maintenance: Your automatic gate barrier, like any other parking protection product, requires periodic maintenance to ensure that it operates properly and safely for as long as possible. Establish a maintenance schedule with your installer; Parklio recommends servicing every 6 months for regular personal use, but the frequency of maintenance may vary depending on the intensity of use. Only qualified personnel should perform any inspections, maintenance, or repairs. Even if you think you know what you're doing, don't try to modify the system, change program parameters, or adjust the device yourself: your installer is responsible all of that. Only authorized installers are permitted to perform final testing, periodic maintenance, and all repairs, and all work documentation is to be kept by the owner.
- Disposal: After the device's operational life has ended, ensure that it is disposed of by qualified personnel and that the materials are recycled or disposed of in accordance with valid local regulations.
- Important: If your gate has a radio control, the function of which appears to deteriorate over time, or has even ceased to function, this could simply be due to the batteries running out (this could be several months to two/three years depending on the type). Before contacting your installer, please ensure that a running out battery is not the source of the problem by exchanging it for one from a working transmitter. If the issue persists, then contact your installer.

2. Parking Gate components

This Section will describe all the components a barrier is made of.

2.1. Gate components overview

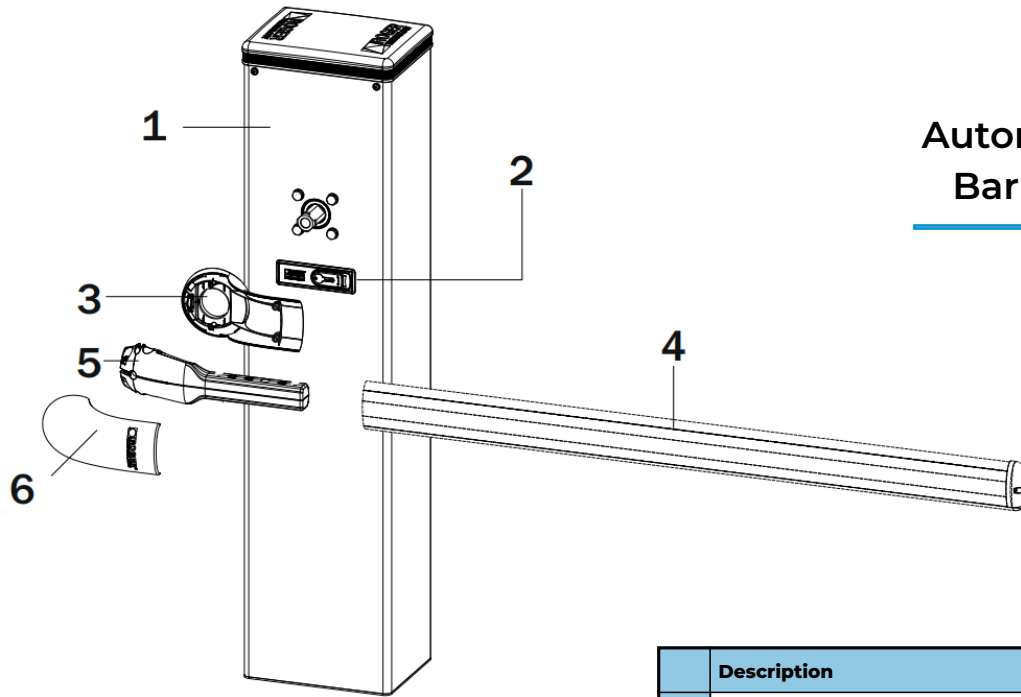

Automatic Gate Barrier parts

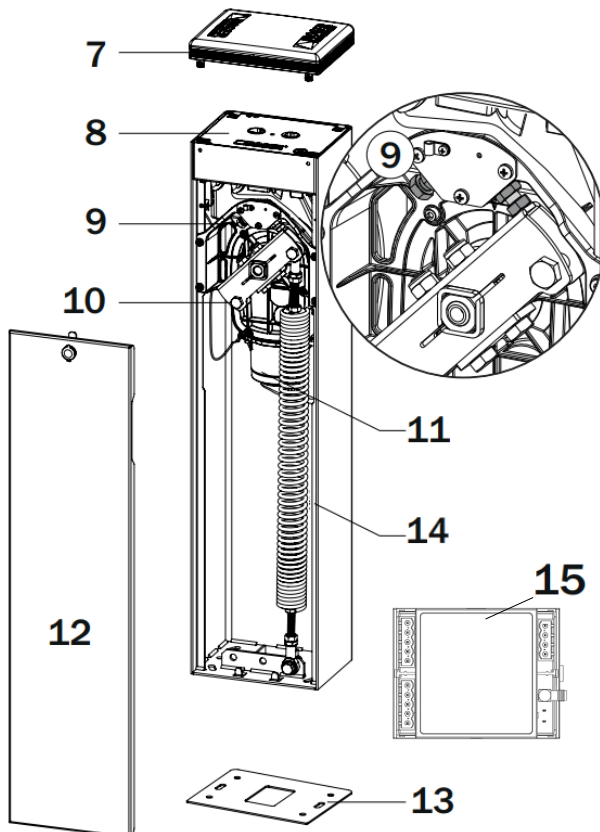

	Description
1	Barrier unit cabinet, in carbon steel with anti-corrosion treatment and painted
2	Key release with standard lock
3	Boom support arm rear cover
4	Elliptical boom up to 3 m, in white painted aluminium with slot cover profiles and shock-resistant rubber
4	Elliptical boom up to 4 m, in white painted aluminium with slot cover profiles and shock-resistant rubber
5	Boom support arm in die-cast aluminium
6	Boom support arm front cover
7	Head in die-cast aluminium with anti-corrosion treatment and painted, complete with diffuser in transparent polycarbonate and BI/BLED led lights
8	Controller unit
9	Gate open/close mechanical stop
10	Steel spring fastening linkage lever
11	Gear motor complete with brushless motor and absolute encoder
12	Corrosion-proof, painted steel inspection hatch
13	Galvanised base plate for barrier fastening
14	Spring
15	Brain for app control

Contact the Parklio support team if any of the parts are incorrect, missing, or damaged. Keep the carton and all original packing materials in case the product needs to be send for repair.

■ 2.2. Dimensions

Parklio Gate 4 m

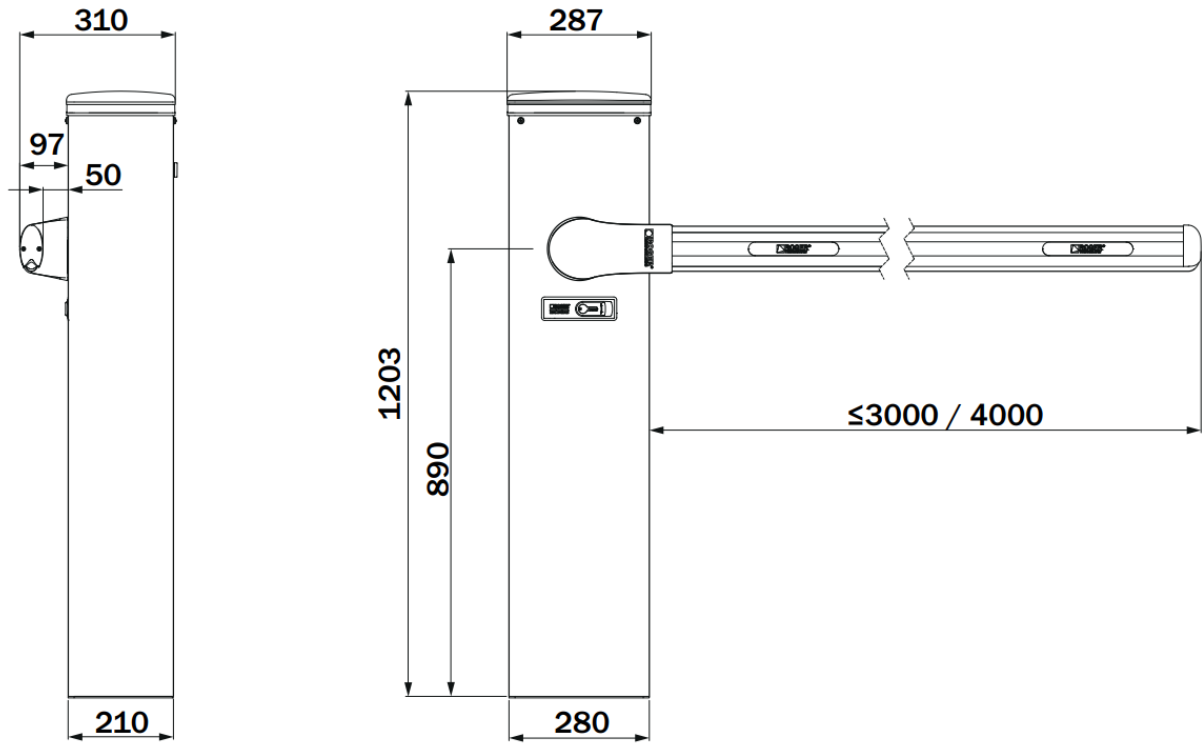

Parklio Gate 6 m

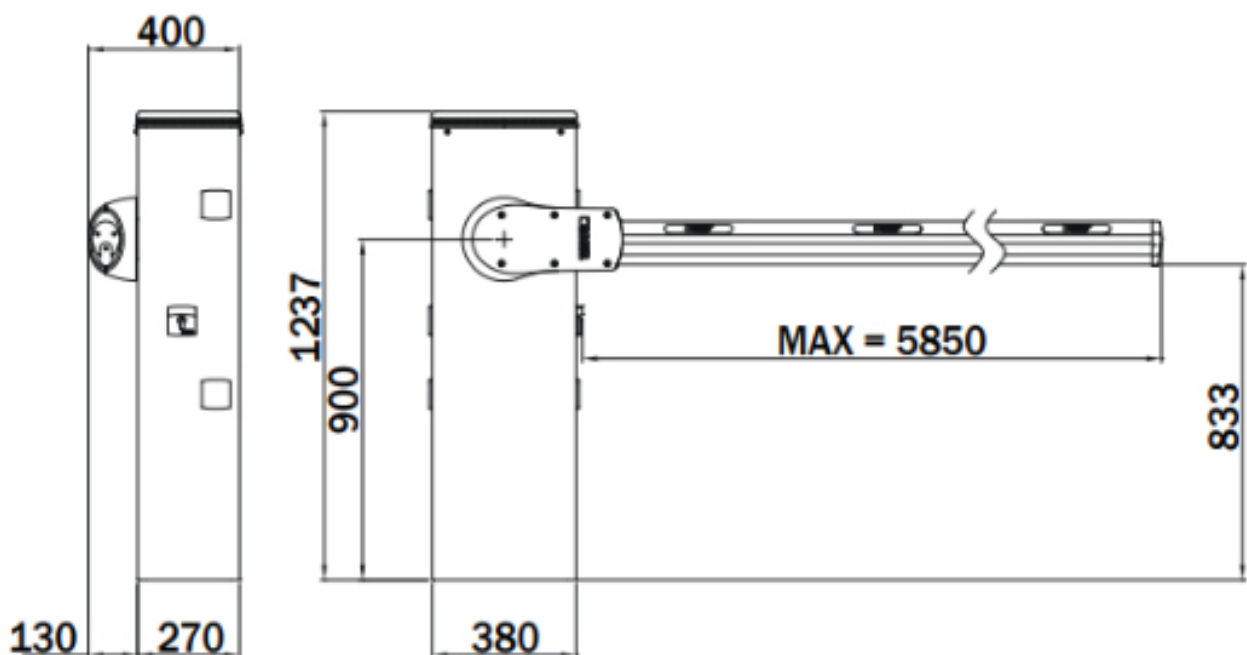

■ 2.3. Technical characteristics

Power supply	230 Vac - 50 Hz +- 10%
Motor power supply	36 Vdc
Power consumption	0 - 15 A
Motor power	220 W
Torque	0 - 200 Nm
Open / Close time	2 - 6 sec
Control system	Absolute digital encoder
Use frequency	Continuous
Operating cycles per day	5000
Grade of protection	IP54
Operational temperature	-20 °C to 55 °C
Accessories power supply	24 Vdc
Boom	2.2 - 4 metres
Backup battery	Optional
Dimensions	210 mm x 287 mm x 1203 mm
Release system	Key with a standard cylinder

Technical characteristics for Parklio Gate 4

Power supply	230 Vac - 50 Hz +- 10%
Motor power supply	36 Vdc
Power consumption	0 - 15 A
Motor power	220 W
Torque	0 - 200 Nm
Open / Close time	4 - 8 sec
Control system	Absolute digital encoder
Use frequency	Continuous
Operating cycles per day	4000
Grade of protection	IP54
Operational temperature	-20 °C to 55 °C
Accessories power supply	24 Vdc
Boom	up to 6 metres
Backup battery	Optional
Dimensions	380 mm x 270 mm x 1237 mm
Release system	Key with a standard cylinder

Technical characteristics for Parklio Gate 6

3. Installation

This section describes how to install the parking Gate barrier. The illustrations provided here are purely for illustrative purposes. Depending on the total size of the installation, the area required for mounting the automatic gate barrier system and accessories may vary. The installer is in charge of selecting the best solution.

■ 3.1. Preliminary checks

- Check that the material received is in good condition and suitable for the application.
- Check that the product's operational restrictions are not exceeded.
- Check that the installation location matches the product's overall space requirements and that there are no barriers impeding open or close operations.
- Check the concrete foundation for the barrier installation. The foundation is to be made completely flat and clean, and it is to be casted in line with standard working methods.

■ 3.2. Installing base plate (up to 4m)

- Excavate a foundation pit measuring 1m x 1m x 0.4m and fill with concrete reinforced with steel mesh.
- Fasten the 4 anchor ties to the plate (fig. 1). N.B.: The bottom nut must be tightened to the end of the thread on the screw so that the length Z is at least 40mm.
- Sink the base plate with the anchors in the centre of the foundation pit, so that the surface is flush with the concrete and perfectly level. The corrugated cable conduits must protrude by a few centimetres from the centre of the plate.

PAY ATTENTION to the installation direction of the plate. See the detailed view in fig.2. The inspection side must be accessible from inside the home / shop / business.

- Installation on existing surfaces. Place the base plate on the surface and trace the positions of the fastener points. Drill the surface and fit 4 expansion anchor bolts (purchased separately)

■ 3.3. Installing the Gate barrier (up to 4m)

N.B.: The barrier is configured by default for installation on the right hand side (viewed from the inspection hatch).

- Undo and remove the washers and nuts from the anchors on the base plate (fig. 3).
- Open the inspection hatch, turning the key clockwise 90° (fig. 4) and remove it.
- Place the cabinet on the plate. The anchors on the base plate must fit through the four slots.
- Fit the washers and nuts removed previously. Move the cabinet as necessary in the slots to adjust the position of the barrier correctly.
- Tighten the nuts securely (fig. 6)

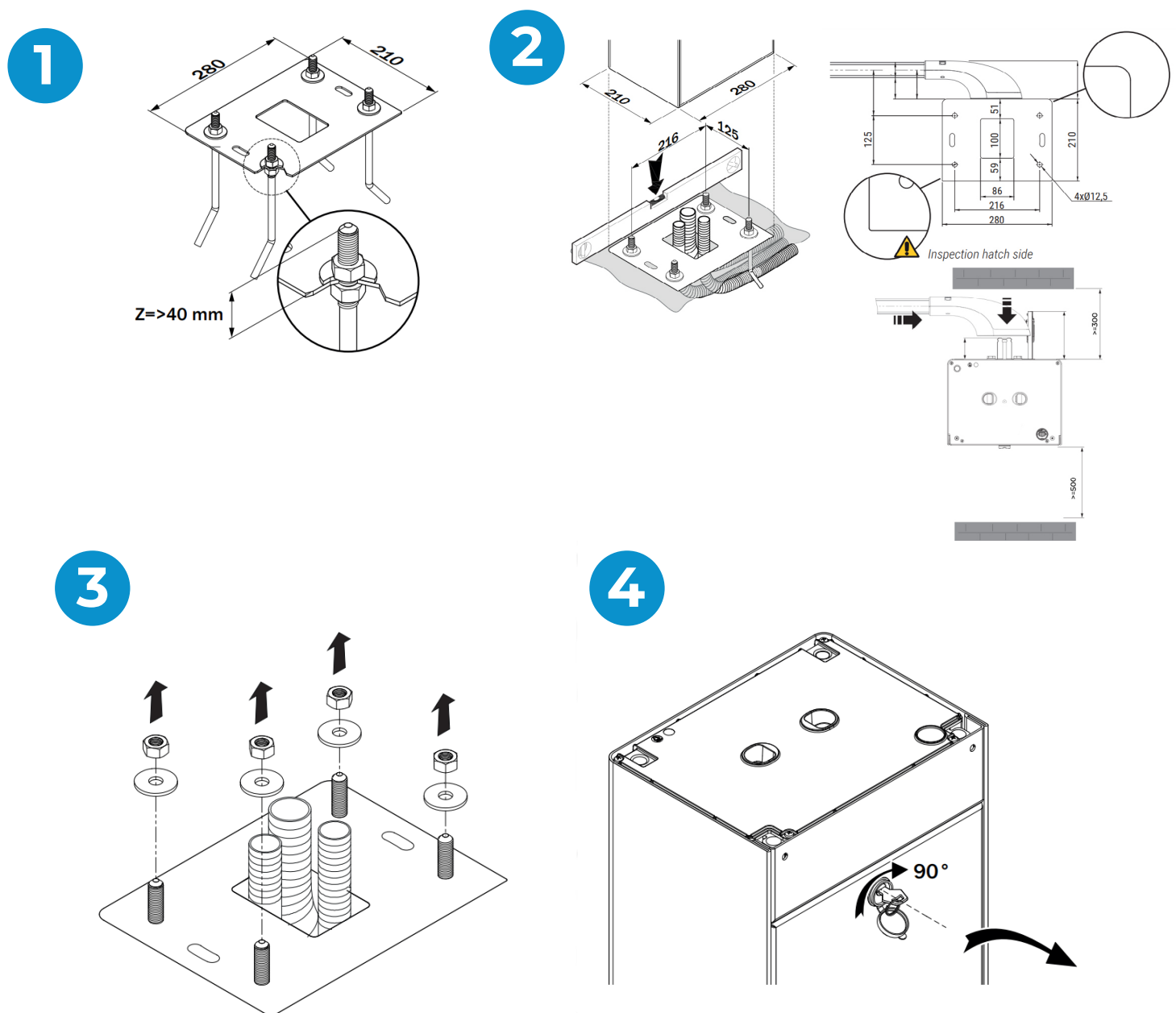

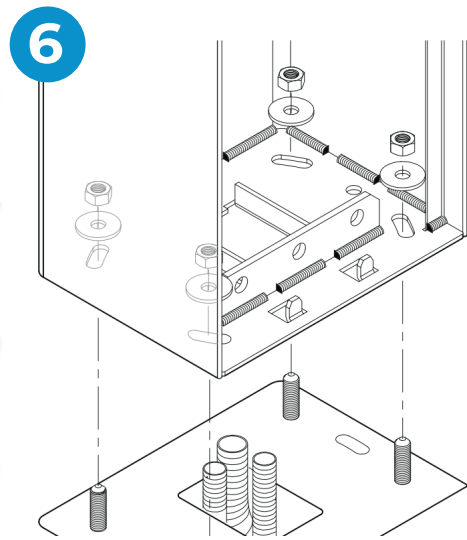
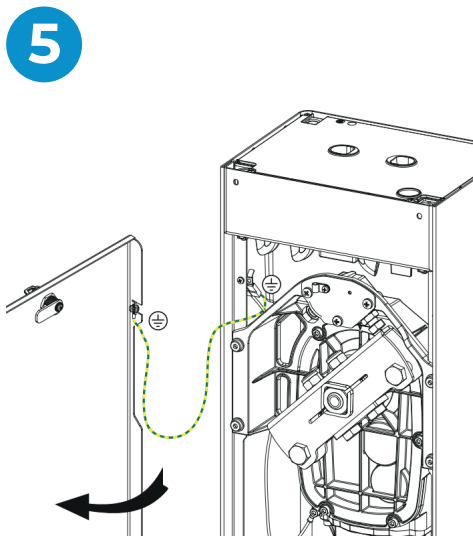

■ 3.4. Installing base plate (up to 6m)

The illustrations here are indicative only. The space necessary for fastening the automation system and the accessories may vary depending on the overall dimensions of the installation.

The installer is responsible for determining the most suitable solution

- Excavate a foundation pit measuring 1m x 1m x 0,4m and fill with concrete reinforced with steel mesh.
- Fasten the 4 anchors ties to the plate (fig. 1). N.B.: The bottom nut must be tightened to the end of the thread on the screw so that the length Z is at least 40mm.
- Sink the base plate with the anchors in the centre of the foundation pit, so that the surface is flush with the concrete and perfectly level. The corrugated cable conduits must protrude by a few centimetres from the centre of the plate.
- **Installation on the existing surfaces.** Place the base plate on the surface and trace the positions of the fastener points. Drill the surface and fit 4 expansion anchor bolts (purchased separately)

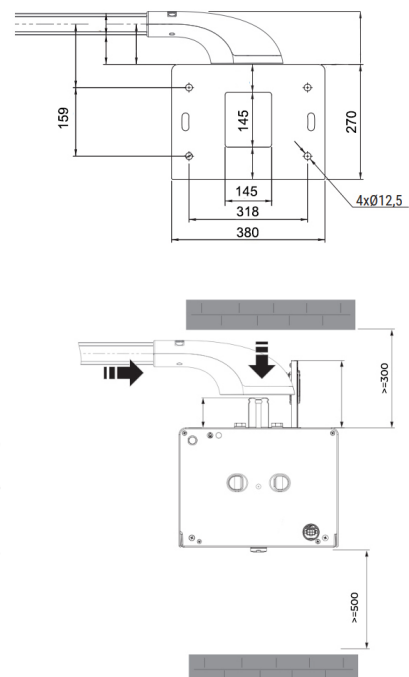
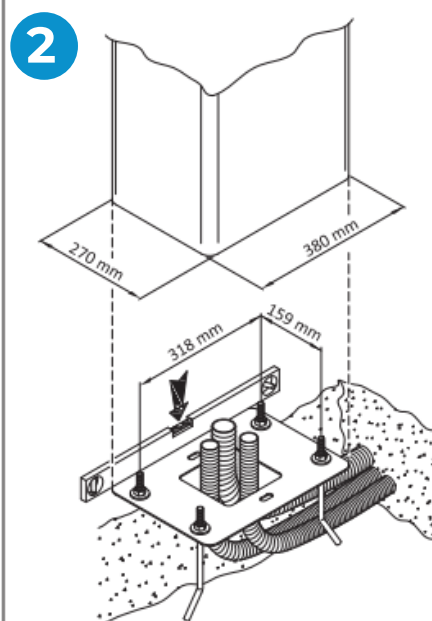
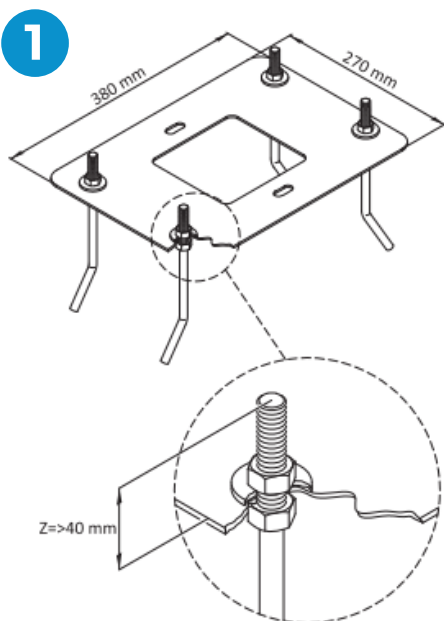

■ 3.5. Installing the Gate barrier (up to 6m)

N.B.: the barrier is configured by default for installation on the right hand side (viewed from inspection hatch side).

- Undo and remove the washers and nuts from the anchors on the base plate (fig. 3).
- Open the inspection hatch, turning the key clockwise by 90° (fig. 4).
- Remove the inspection hatch (fig. 5).
- Place the cabinet on the plate. The anchors on the base plate must fit through the four slots.
- Fit the washers and nuts removed previously. Move the cabinet as necessary in the slots to adjust the position of the barrier correctly. Tighten the nuts securely (fig. 6).

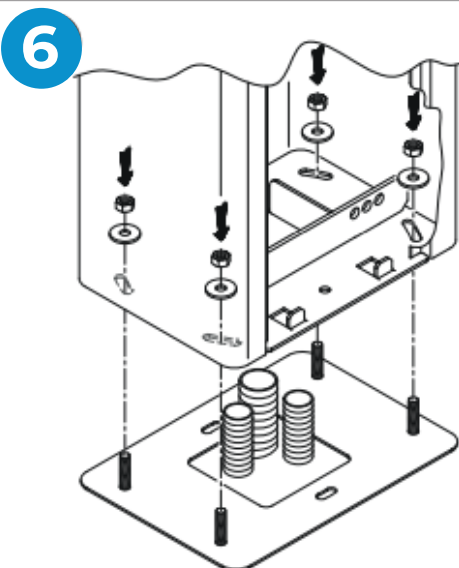
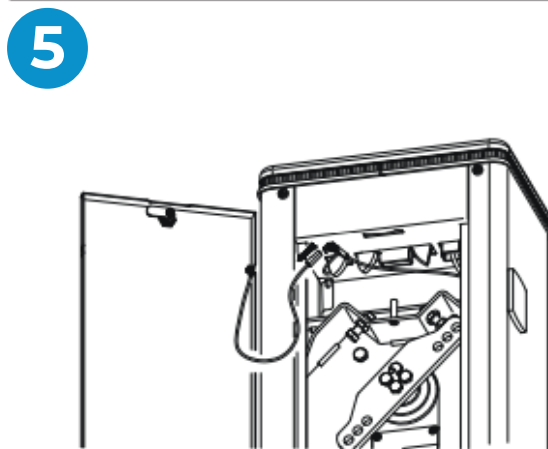
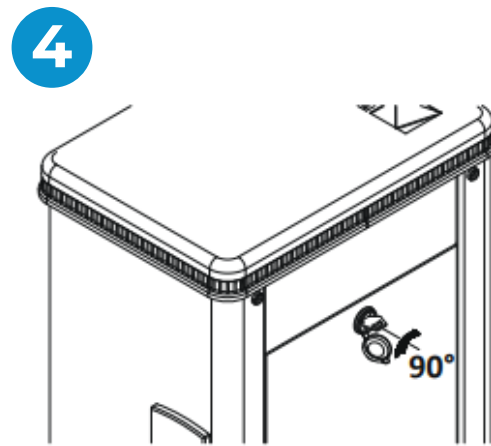
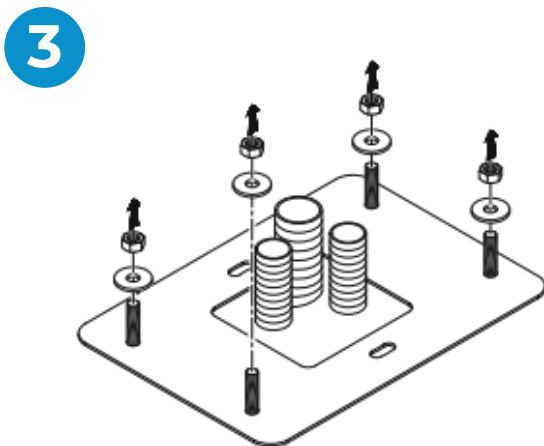

■ 3.6. Installing the Gate barrier



Parklio Gate barriers are configured by default for installation on the right hand side (seen from the inspection hatch side).



Whenever corrective actions are carried out, pay the utmost attention when releasing, locking or moving the internal mechanical parts. These operations could be hazardous for the installer.

**OPENING
ON THE LEFT**

**OPENING
ON THE RIGHT**

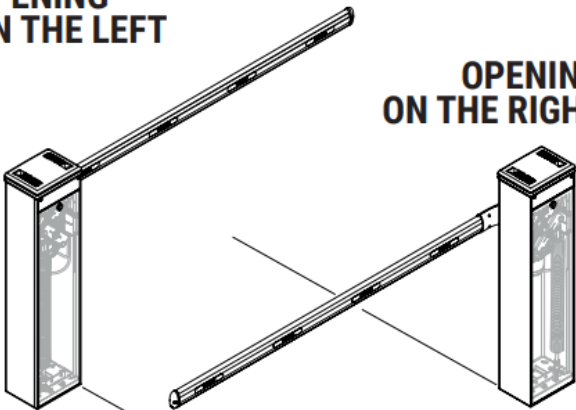

Direction of the barrier installation

For left hand installations:

- Unlock the barrier.
- Turn the linkage lever as shown in figure.
- Move the mechanical stop.
- Lock the barrier.
- Change the Brain wiring by switching the positions of IO 1 and IO 0 wires

7

**BARRIER INSTALLED ON THE RIGHT (SEEN FROM THE INSPECTION HATCH SIDE)
AND THE BOOM OPENING/CLOSURE GATE ON THE LEFT**

**BARRIER INSTALLED ON THE LEFT (SEEN FROM THE INSPECTION HATCH SIDE)
AND THE BOOM OPENING/CLOSURE GATE ON THE RIGHT**

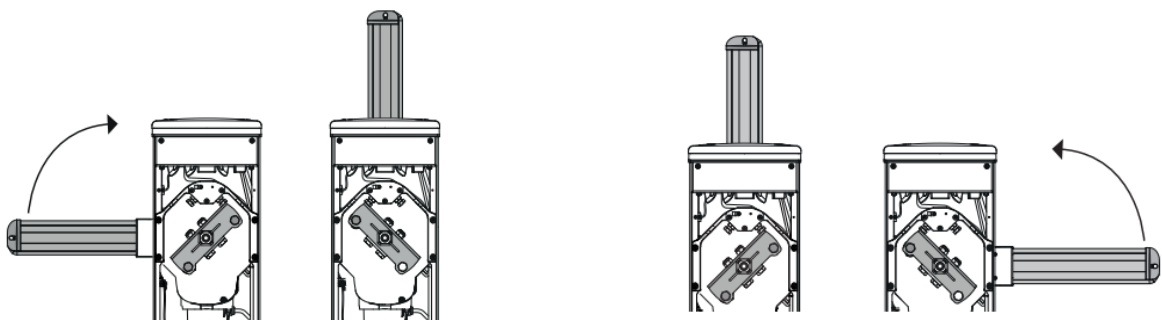

■ 3.7. Support and boom installation

- The boom is set and installed in the upper position.
- Unscrew the screws [G] TCC 4.2x13 and remove the cap [H] and Unscrew the screws [I] TCC 2.9x19. Remove the support [L],
- Open the boom support cover [A] by unscrewing the self-tapping screws TCC 4.2x19 [B]
- Loosen the screws [E1] and insert the boom support [C] on the drive shaft [D] making sure that there is a maximum distance of 1 mm between support and the barrier cabinet, as shown in the detailed view-
- Fasten the support with the TCEI M8x35 screws [E1], [E2] and [E3] tightening them securely.
- Fasten the rear cover with the provided self-tapping screws [F] TCC 4.2x19.
- Insert the boom [O] in the support [C]
- Move the shock-resistant rubber [M] and the profile [N] at least 200 mm.
- Fasten it with the provided screws TCEI M8x20 [P] (complete with washers).
- Lower the boom by following the instructions from chapter Release and lock procedure
- Reposition the profile [N], the shock-resistant rubber [M]
- Reposition the plastic support [L] and fasten them with the screws [I] TCC 2.9x19.
- Fasten the cap [H] with the screws [G] TCC 4.2x13.
- Fasten the plastic support cover [A] with the self tapping screws TCC 4.2x19 [B].

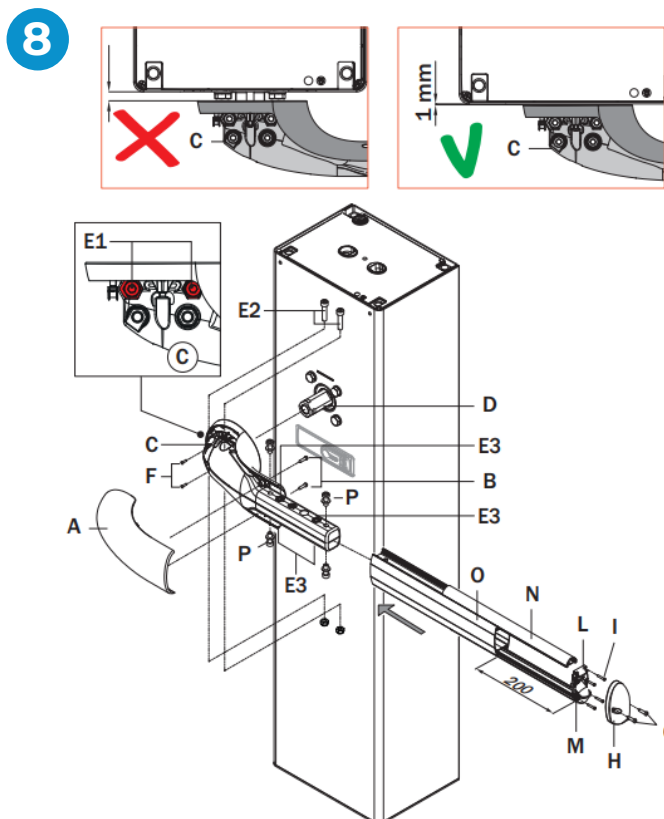

The boom in the picture is set in the down position and is only used to show the positions of the parts. The boom installation must be done when the boom is in the upper position.

4. Electrical connections

All electrical connections must be made with the unit disconnected from mains power and, if applicable, battery power.

Before connecting to electrical power ensure that the mains power specifications on the identification plate match the mains power supply used.

A switch or an omnipolar cut-off switch with a contact opening of at least 3 mm must be installed on the mains power line.

Ensure that an adequate residual current circuit breaker and a suitable overcurrent cut-out are installed ahead of the electrical installation.

Use a 3x2.5 mm² double insulated cable for the mains power line. Feed the cable on the left hand side of the barrier through the rubber cable grommet on the left hand side of the controller casing and connect it to the terminals L (brown), N (blue) and \perp (yellow/green) inside the automation unit.

Fasten the power cable with the cable grips included.

At least 50 mm of the connector cable conduit must protrude from the holes in the base plate and into the automation unit.



Please note that installation cables are not included with our product since the proper cable length varies based on the installation site. Consult with your installer or a qualified professional who can accurately determine the suitable cable length required for your specific installation needs.

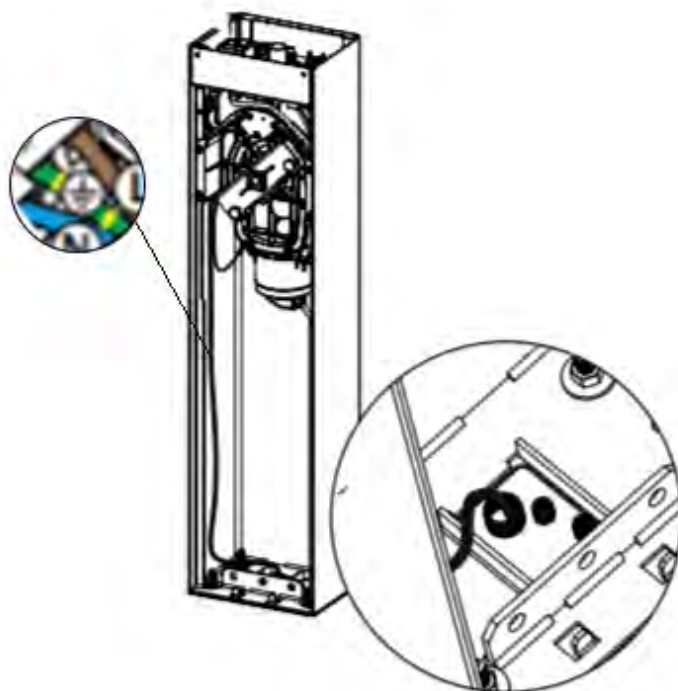

5. Installation of the Gate cover

Installation of the cover for the gate (2,5-4 metres)

1. Insert the connector [B] in the LIGHT terminal of the control unit.
2. Fasten the cable grommet [C], making sure it is positioned correctly.
3. Insert the antenna through the grommet [D] and connect it to the Parklio brain
4. Position the Head [A] on the barrier.
5. Tighten the fastening screws.

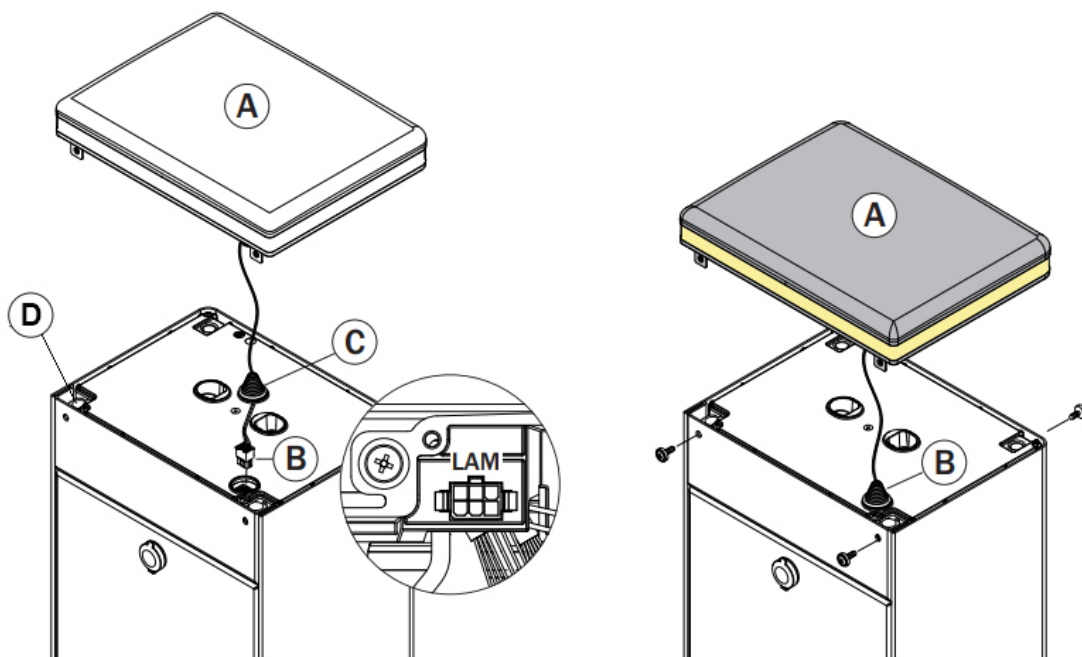

Installation of the cover for the gate (5-6 metres)

1. Insert the connector [B] in the LIGHT terminal of the control unit.
2. Fasten the cable grommet [C], making sure it is positioned correctly.
3. Insert the antenna through the side and connect it to the Parklio brain
4. Position the Head [A] on the barrier.

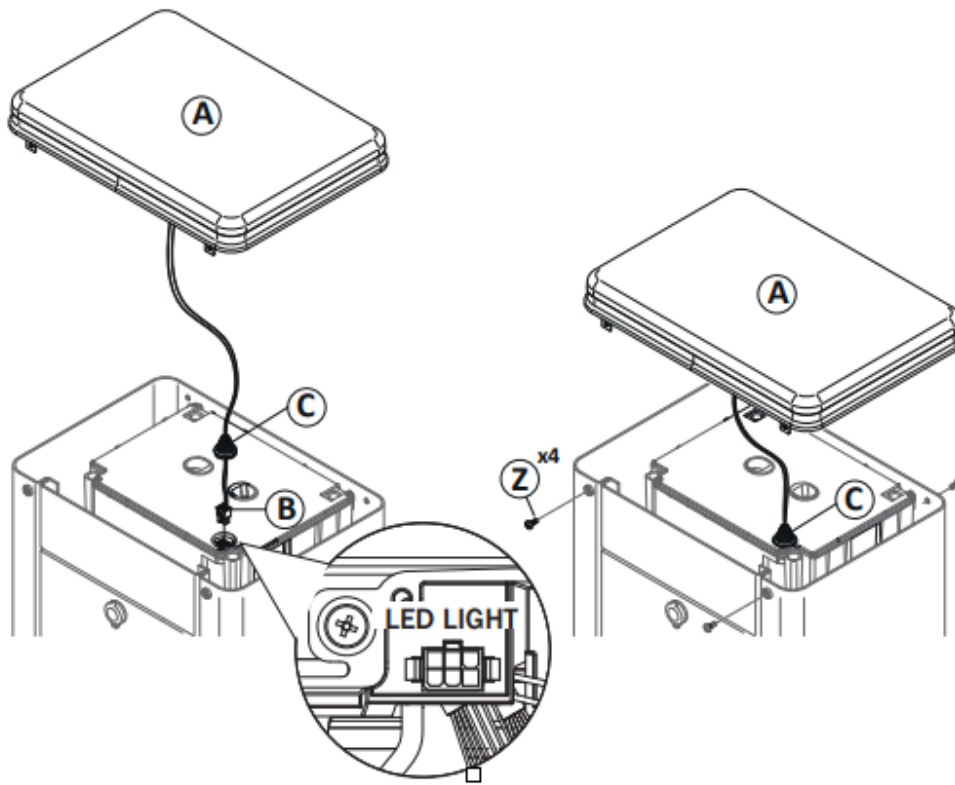

6. Release and lock procedure

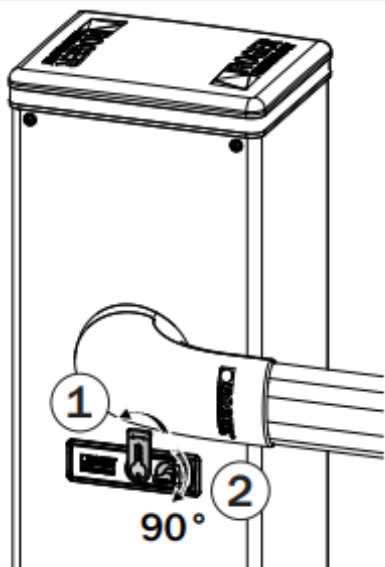

FIG. 1

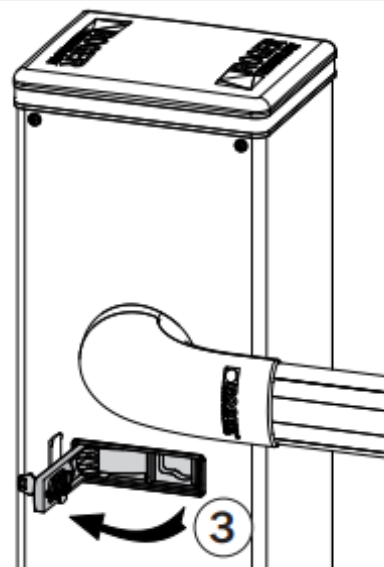

FIG. 2



Whenever corrective actions are carried out, pay the utmost attention when releasing, locking or moving the internal mechanical parts. These operations could be hazardous for the installer.

Unlock the barrier in the event of a power outage or before performing scheduled maintenance or repairs. The unlock procedure must be performed with the boom in the closed position. Ensure that there are no persons, objects or animals within the operating radius of the barrier when unlocking.

RELEASE AND MANUAL OPERATION

Open the lock cover as indicated in step 1.

Insert the key included into the lock and turn clockwise by 90°, as indicated in step 2.

Open the release cover completely (3).

Move the boom manually.

RESTORING AUTOMATIC OPERATION

To relock the boom, close the release cover by turning the key 90° clockwise, paying attention to your fingers.

With the release cover closed, turn the key 90° anticlockwise.

Remove the key and close the lock cover.

7. Controlling the Gate

This section will provide detailed instructions on how to connect the mobile application with the parking Gate and how to control the Gate using the free Parklio connect mobile application.



Please note that internet connectivity is required for the gate's first connection and setup.

7.1. Installing the application

The application can be downloaded by scanning the following QR codes:

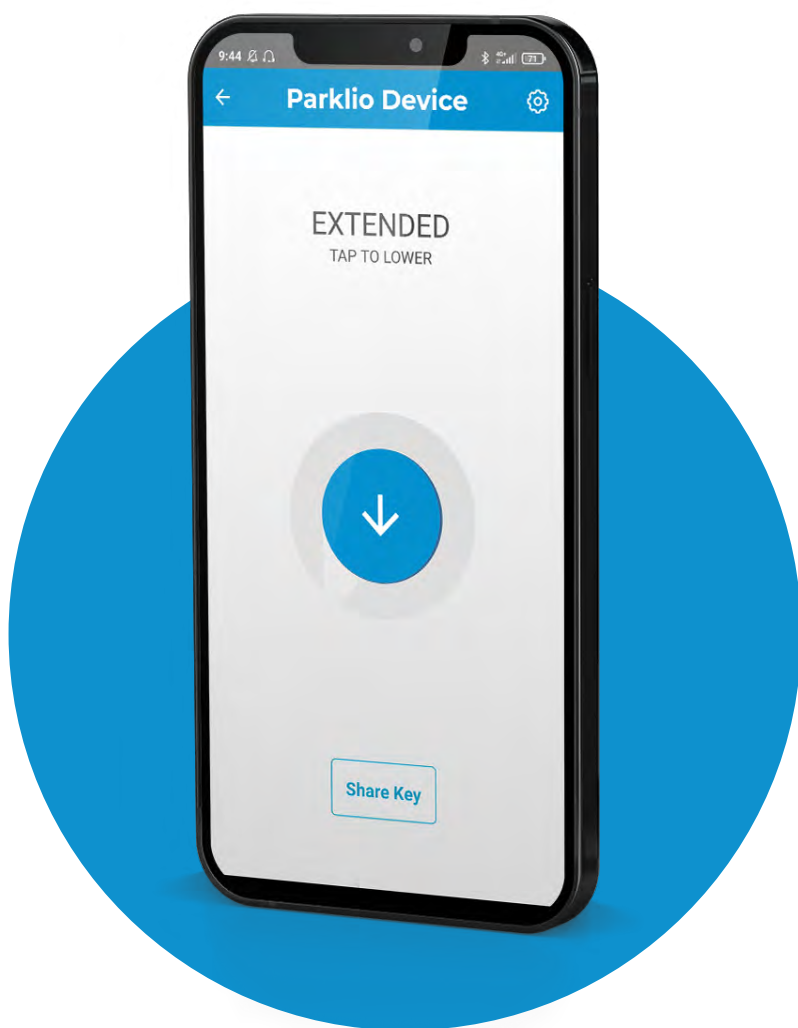

Android



iOS



Huawei



Or on the following links:

Android - <http://bit.ly/2iMkIn5>

iOS - <https://apple.co/2iaV7aA>

Huawei - <https://urldre.cloud.huawei.com/mCe8Pn0uD6>

■ 7.2. Register and login

To use Parklio Connect the user needs to be logged in. An user may login with an existing Google account, an Apple account, or the user may create and use a Parklio account with their email.

EMAIL
Enter Email

PASSWORD
Enter Password

Login

Sign up Forgot password?

OR

Sign in with Google

By clicking Login or Signup indicates you agree with our Terms and Privacy Policy

Parklio™ © 2021

Create an Account

EMAIL

PASSWORD

CONFIRM PASSWORD

Sign up

By clicking Login or Signup indicates you agree with our Terms and Privacy Policy

Parklio™ © 2021

To login via Google simply press the *Sign in with Google* button.

To login via Apple account simply press the *Sign in with Apple ID* button.

If the user has an existing Parklio account enter the email and password associated with the account into the corresponding fields and press Login.

In case a Parklio account has not been created previously press the *Sign Up* button which will open a new screen. There the user may input his email and password to create an account. After an account has been created the user may use his credentials to login into the application.

■ 7.3. Adding the barrier

After logging in the dashboard containing all added Parklio devices will be displayed.

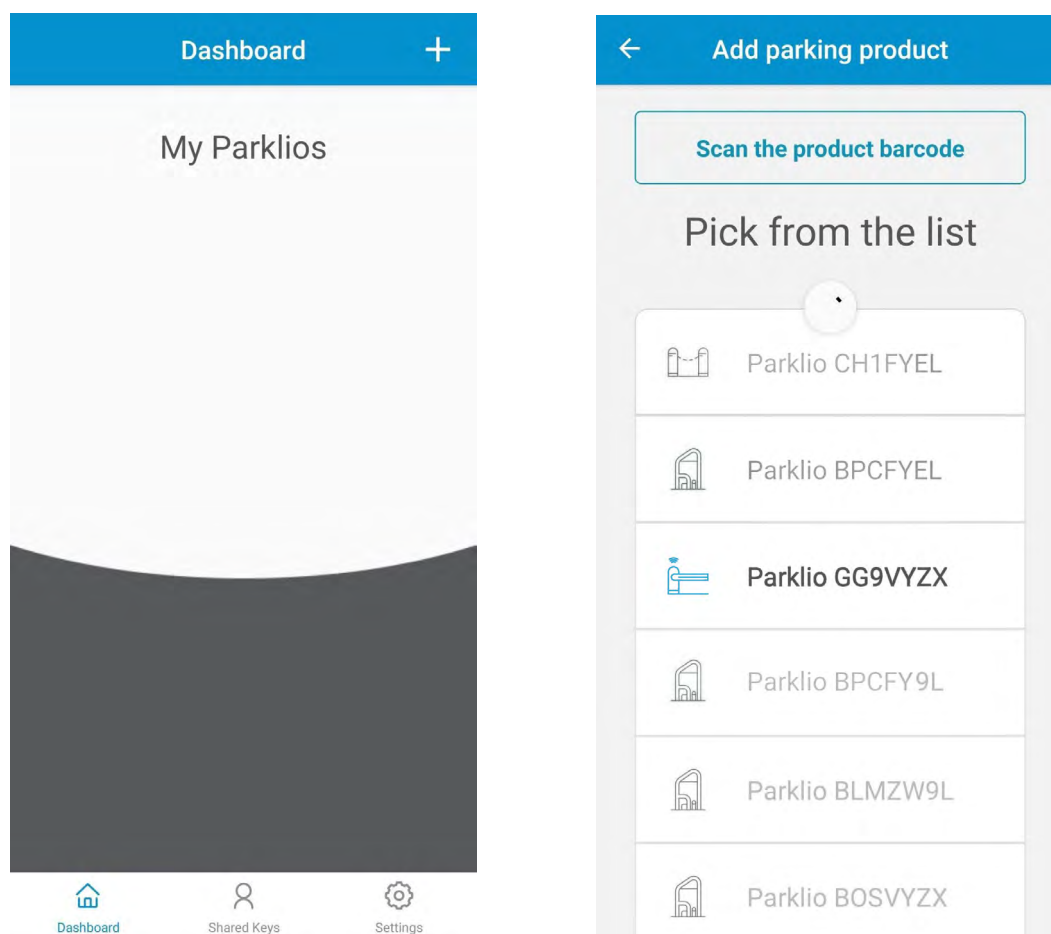

To add a barrier to the account press the + button on the top right corner of the dashboard. The Add parking product screen opens and the smartphone starts scanning for nearby Parklio devices. This step should be done in close proximity to the Parklio device being added.

Grayed out devices represent Parklio devices that are already set up. When the scanning is complete select the device to add from the list of available devices. The device will be set up automatically and added to the users account.

In the above example screenshot by clicking on *Parklio BPCFYEL* the application starts the process of setting the barrier up. The process is automatic and the user is notified at the end.

■ 7.4. Connecting to the Gate

On the Dashboard click on the Gate to connect to.

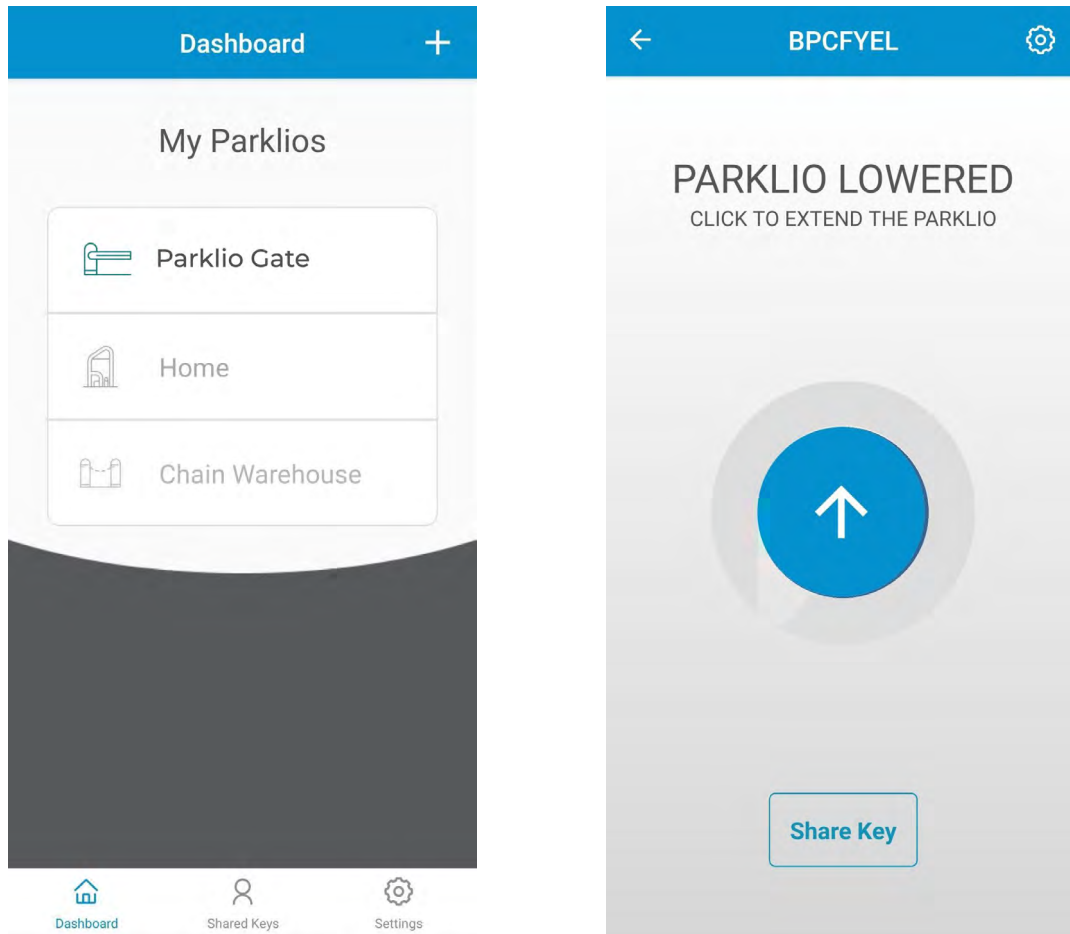

After a successful connect the screen will show the Gate status:

- **PARKLIO LOWERED** - Indicates the Gate is down (open)
- **PARKLIO EXTENDED** - Indicates the Gate is up (closed)
- **PARKLIO EXTENDING** - Indicates the Gate is moving up (closing)
- **PARKLIO LOWERING** - Indicates the Gate is moving down (opening)
- **AUTHENTICATION FAILED** - There was an error with communication to the Gate or with the Gate digital key, the key was probably reset.

■ 7.5. Opening and closing the gate

Opening and closing of the Gate is possible only when the user is connected to the Gate and while the Gate is in the EXTENDED or LOWERED state.

By clicking the button in the centre of the main screen the Gate will open or close.

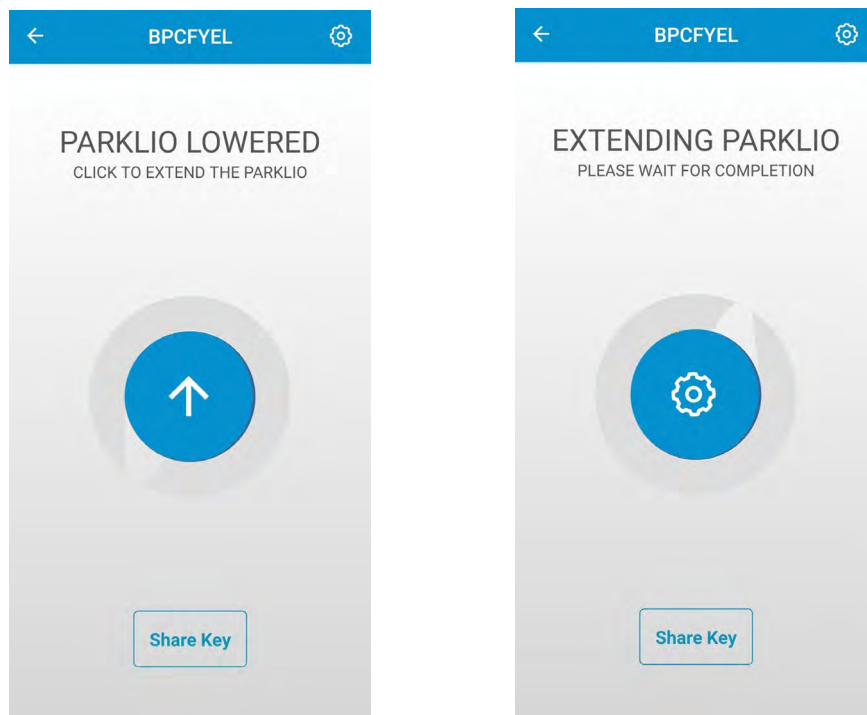

■ 7.6. Gate settings and information

Clicking the gear icon in the top right of the Gate screen will bring up the Gate settings. In the settings screen it is possible to view device information like the firmware version and ID.

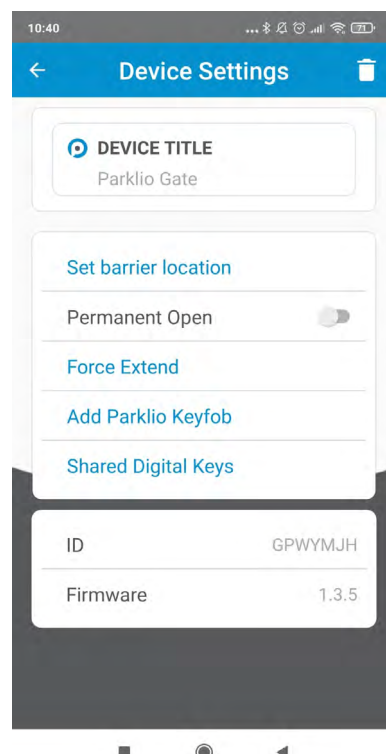

Change the device name

Parklio devices allow the user to change their name, so they can be more easily identified. To change the device name click on the *DEVICE TITLE* in the settings. Change the name of the device and click *SAVE*. The new name will now be displayed.

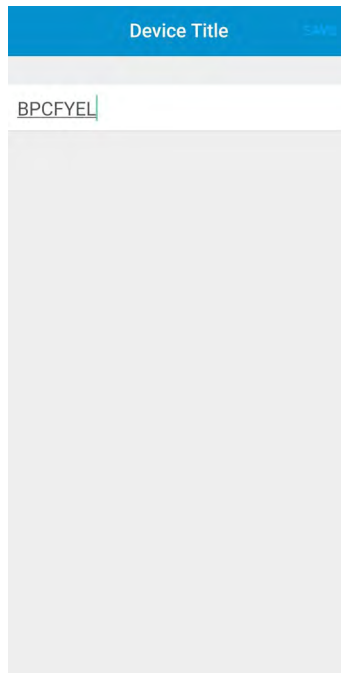

Key sharing

An important feature of all Parklio products is the option for key sharing. The application allows the owner of the device to share the digital key of his device.

To use this feature an internet connection is required. It is not required to be connected to a gate via bluetooth.

All keys have a validity period, the key becomes active at the start date and is valid until the end date. A key may be shared to multiple users and multiple keys may be sent to one user. In order to share a key press the *Share Key* button on the main barrier screen.

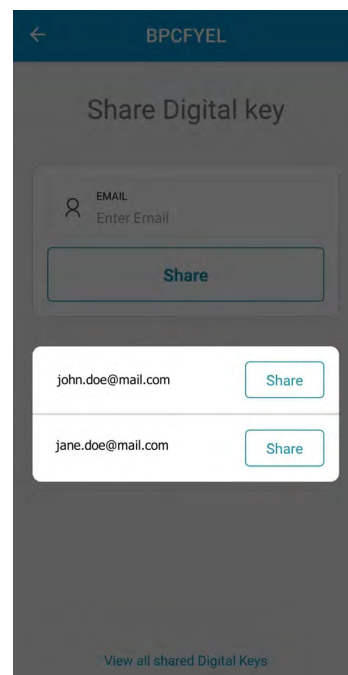
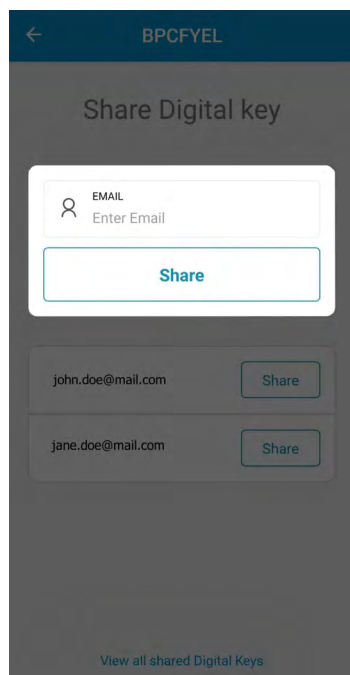

The first step is to enter the email of the user to whom the key will be shared or to choose from the list of previously shared users.

Next, it is required to select the key *START TIME* and *END TIME* using the calendar. After the start and end time are set press the Share Key button and confirm.

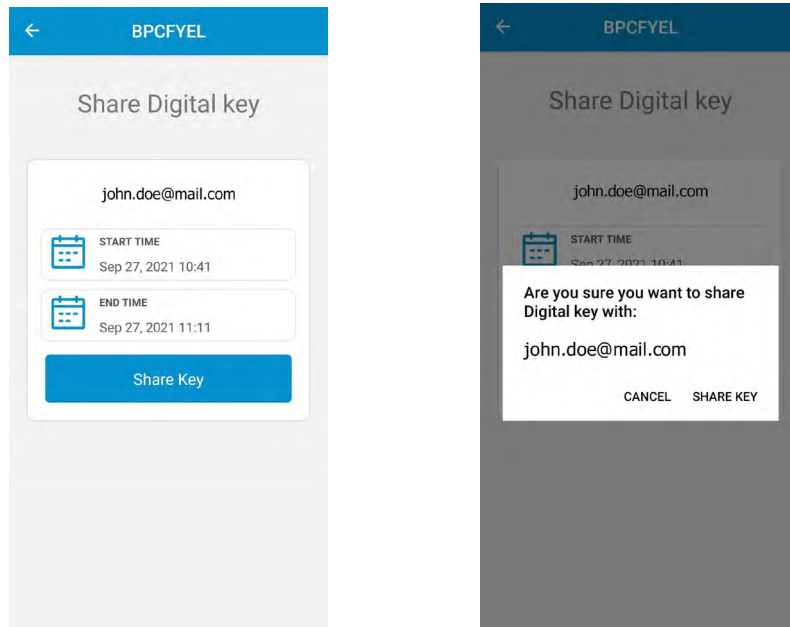

Blocking shared keys

If it is necessary to remove access from a user to whom a key was shared it is possible to do this from the Parklio Connect application.

To use this feature an internet connection is required. It is not required to be connected to a barrier via bluetooth.

In the *Device Settings > Share Digital Key* screen, press the *View all shared Digital Keys* at the bottom of the screen. All keys shared for the selected device are displayed. To block a certain user click on the *Block* button next to the user. Share keys can also be viewed from the *Device Settings* screen by clicking on *Shared Digital Keys*.

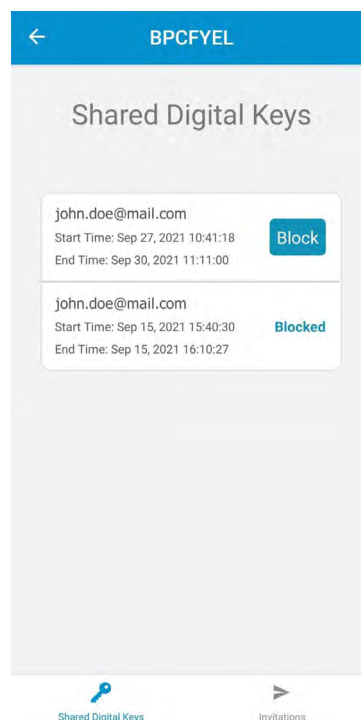

Removing the Gate

In order to remove the Gate from the account or to delete a key which was shared to the account enter the Device Settings screen and press the garbage can icon. A confirmation will pop up, press Yes. **When a device is deleted from the account all sent guest keys are still valid. They can only be invalidated by performing a barrier key reset or when the barrier is added to another account.**

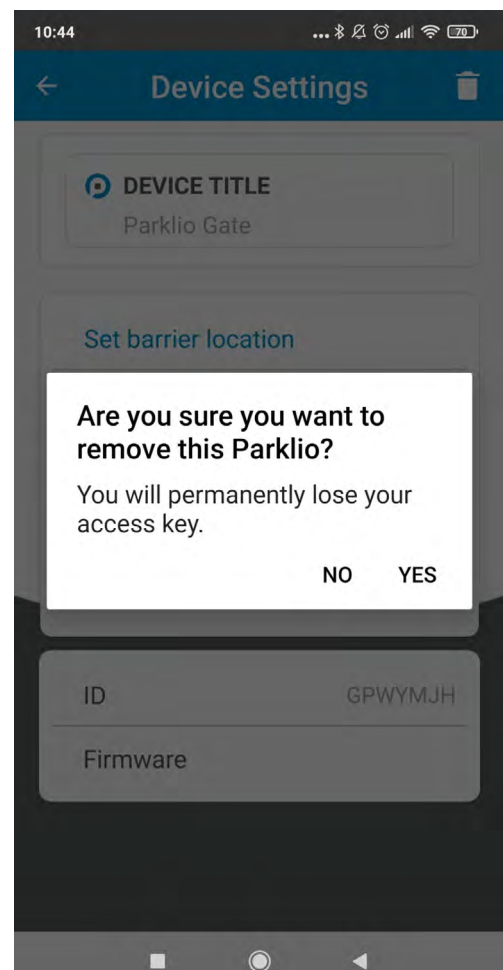
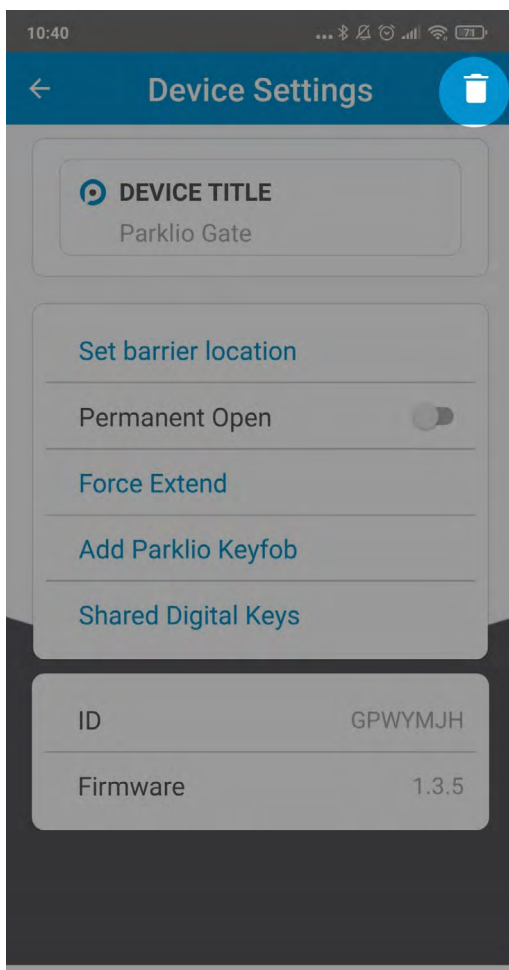

■ 7.8. Gate key reset

The Gate digital key is set once the Gate is added to a user account. This key can only be removed by resetting it. The reset is done by pressing and holding the Reset button for 3 seconds, until the green LED lights up.

When the gate is reset it can be added again to a user account via the Parklio Connect application.



Resetting the Gate digital key will cause all the shared guest keys and the owner key to be unusable. It will be necessary to resend all guest keys individually.

8. Maintenance

N.B.: Only use original spare parts when repairing or replacing products.

The installer must provide the user with complete instructions for using the motorised door or Gate in automatic, manual and emergency modes, and must hand the operating instructions to the user of the installation upon completion.

The installer must compile the maintenance log book, in which all scheduled and unscheduled maintenance operations performed must be indicated.

- The installation is a subject to regular maintenance. We recommend servicing at least once every 6 months.
- Disconnect from mains electricity and from battery power (if applicable) to avoid the risk of accident or injury.
- Check the tightness of all the fastener screws and nuts.
- Clean the photocell lenses with a cloth moistened slightly with water. Do not use solvents or other chemical products, as these may damage the electronic components.
- Clean and lubricate the pivot points with lithium based grease (EP LITIO).
- Check the electrical connections.
- Check that the manual lock release system works.
- Check that the boom is balanced correctly as indicated in chapter 12.
- Check that there are no plants within the radius of action of the boom which could interfere with the photocells or with the movements of the boom itself.
Reconnect to mains power
- Check that the safety devices and all the control functions work correctly.
- Check that the obstacle detection function works correctly.
- Check that there is no risk of the boom accidentally lifting persons or objects.
- Check that the force limiting function prevents potentially dangerous situations in compliance with the standard EN 12445.

9. Disposal

This product may only be uninstalled by qualified technical personnel following suitable procedures for removing the product correctly and safely.

This product consists of numerous different materials. Some of these materials may be recycled, while others are to be disposed of correctly at the specific recycling or waste management facilities indicated by local legislation applicable for this category of product. Do not dispose of this product as domestic refuse. Observe local legislation for differentiated refuse collection, or hand the product over to the vendor when purchasing an equivalent new product.

Local legislation may envisage severe fines for the incorrect disposal of this product.

Warning! Some parts of this product may contain substances that are harmful to the environment or dangerous and which may cause damage to the environment or health risks if disposed incorrectly.

10. Safety warnings

This section contains safety instructions that will help to protect you from risk of injury or property damage. All warranties will be voided if these instructions are not followed.

- If you have not read and understand the operating instructions, do not use the gate barrier.
- Before using the gate barrier for the first time, make sure that all the parts listed in these instructions are inside of the original packaging.
- Only plugs, batteries, chargers, spare parts and power supplies, supplied by the manufacturer of the barrier should be used. The use of non-manufacturer supplied components will result in the termination of warranty.
- Ignoring use instructions, as well as inappropriate installation and use of the gate, may result in gate damage or user injury. Always have instructions on hand.
- Never expose the inner workings to water.
- The device is to be exclusively installed on a hard, flat concrete floor.
- The device and external supply must be disconnected from power supply during installation, maintenance, cleaning and repairs.
- Leave the barrier repairs to a specialist. Improper repairs may lead to an accident or a malfunction in the unit.
- Please charge the battery to full capacity before first use.

- Only charge the battery pack with the provided power adapter.
- The battery pack is fragile, please handle it with care. Do not expose the battery to direct heat.
- The battery pack is intended to be used only with Parklio products, use with other products is not recommended. Parklio is not responsible for any damage caused to the equipment or the battery pack when used incorrectly.
- Make sure to close the power input plug of the battery pack before use to seal the port from water ingress.
- The warranty does not cover consumable parts of the device, colour fading and chipping, increased noise as a result of ageing of the device and other aesthetic effects that do not affect its functionality or safety. Never use chemical solvents on the product as it may cause an explosion.
- Strictly follow the instructions for proper installation and connection to the electrical network.
- The installer is to provide a device (e.g. magnetothermic switch) ensuring the omnipolar sectioning of the equipment from the power supply. The standards require a separation of the contacts of at least 3 mm in each pole (EN 60335-1).
- Installation requires mechanical and electrical skills, therefore it shall be carried out by qualified personnel only, who can issue the Compliance Certificate concerning the whole installation.
- The upstream electric system shall comply with the laws and rules in force.
- Do not install the product in explosive environments and atmospheres, the presence of inflammable gases or fumes is a serious safety hazard.

PARKLIO (PARKLIO D.O.O.) HAS THE RIGHT TO MODIFY THE DEVICE WITHOUT PREVIOUS NOTICE. PARKLIO (PARKLIO D.O.O.) DECLINES ANY RESPONSIBILITY FOR DAMAGE OR INJURY TO PEOPLE OR THINGS CAUSED BY IMPROPER USE OR WRONG INSTALLATION. THE APPLIANCE HAS BEEN ESTABLISHED ACCORDING TO ALL VALUENT SAFETY CRITERIA AND STANDARDS. HOWEVER, WE RECOMMEND THAT WITHOUT THE NEEDED HELP AND SUPERVISION, CHILDREN, A PERSON OF DISABLED PHYSICAL, MOTOR OR PERSONAL EQUALITY AND RELATED PEOPLE WITHOUT PREVIOUS EXPERIENCE OR KNOWLEDGE DO NOT USE THE BARRIER. EXCEPTION IS THE DEVICE USAGE UNDER ADEQUATE SUPERVISION, IF THEY HAVE RECEIVED SAFETY INSTRUCTIONS AND TRAINING, OR IF THEY ARE INFORMED ABOUT THE DANGER CAUSED BY IMPROPER USAGE. THE SAME RECOMMENDATION IS FOR JUVENILES AND THEIR USAGE OF THE DEVICE. DO NOT ALLOW CHILDREN TO PLAY WITH THE DEVICE. DO NOT LET CHILDREN CLEAN THE DEVICE, USE IT, NOR MAINTAIN IT, WITHOUT ADEQUATE SUPERVISION.

11. FAQ

1. How do I reset the Gate digital key?

The barrier can be reset by holding the reset button on the Parklio brain control unit for 3 seconds. The green LED should turn on indicating a successful reset.

2. At what range can I use the Gate?

The Gate uses Bluetooth Low Energy to communicate with your smartphone. Typical range is 100 metres but in normal urban conditions it ranges around 30 m - 50 m.

3. I can't connect to the Gate!

In case you can not connect to the Gate, and you have administrator privileges, reset the application and retry. If the error reoccurs, open the service doors and reset the Gate via the „RESET“ button on the Parklio brain control unit.

4. Do I need to be connected to the internet to use the Gate?

To use the barrier, you do not need either a mobile or WiFi connection. A mobile connection is needed only when initially setting up the barrier and when using shared keys.

5. What do I do if an „Authentication key already set“ message appears during connection to the gate?

You need to reset the gate to factory settings before pairing up your new phone to the gate. In order to restart the gate, you have to hold the reset button on the Parklio Brain control unit for 3 seconds.

6. The application does not display any Gate when scanning?

Make sure that Mobile Data, Bluetooth and Location permissions are enabled.

Declaration of Conformity

In conformant with the legal requisites of the following directives:

- Directive **2006/42/CE** (Machinery Directive) and subsequent amendments;
- Directive **2014/35/UE** (Low Voltage Directive) and subsequent amendments;
- Directive **2011/65/UE** (RoHS Directive) and subsequent amendments;
- Directive **89/106/CEE** (CPD Directive) and subsequent amendments;

and that all the standards and/or technical requirements indicated as follows have been applied:

EN 61000-6-3

EN 61000-6-2

EN 13241-1

The last two digits indicate the year that marking was applied **CE 17**